

③
C-97

PAY 4 PARK LOT AT 1340M ROAD GREEN HILL CHS TO SAPPHIRE HEIGHT BLD. ROAD

DEVELOPER'S PLAN

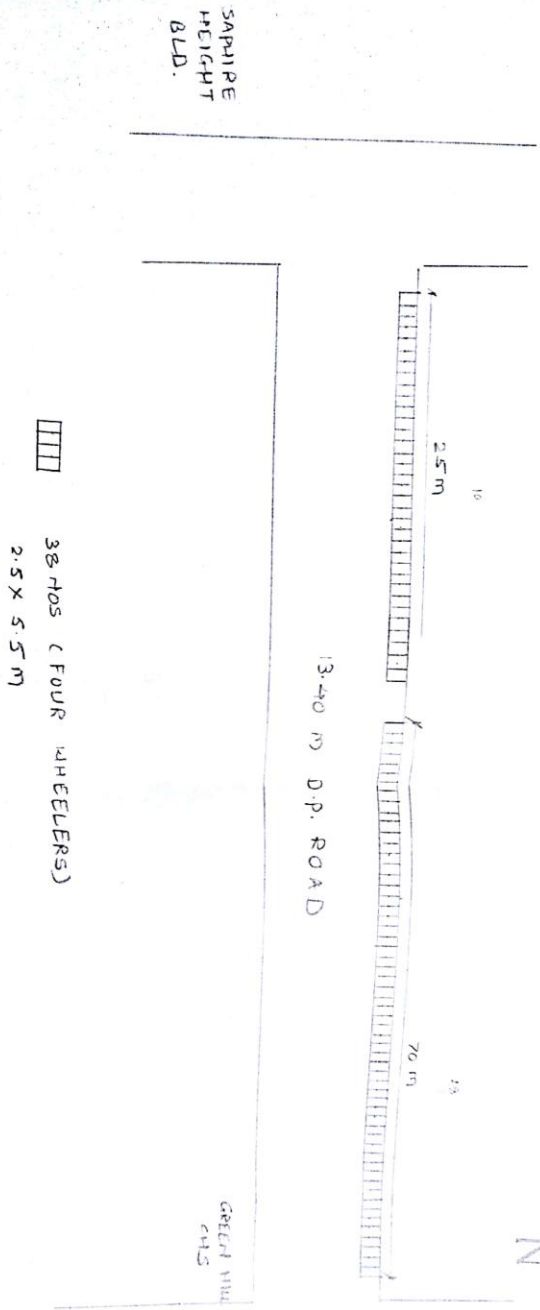

38 HOS (FOUR WHEELERS)
2.5 X 5.5 M

②
56 (m)

46 (m)

7
12/89

PAY & PARK LOT AT 13.40 M ROAD ANITA VIHAR GAS TO ANUDATTA SCHOOL

DRD NO. ACP/PS/1481/2004
N

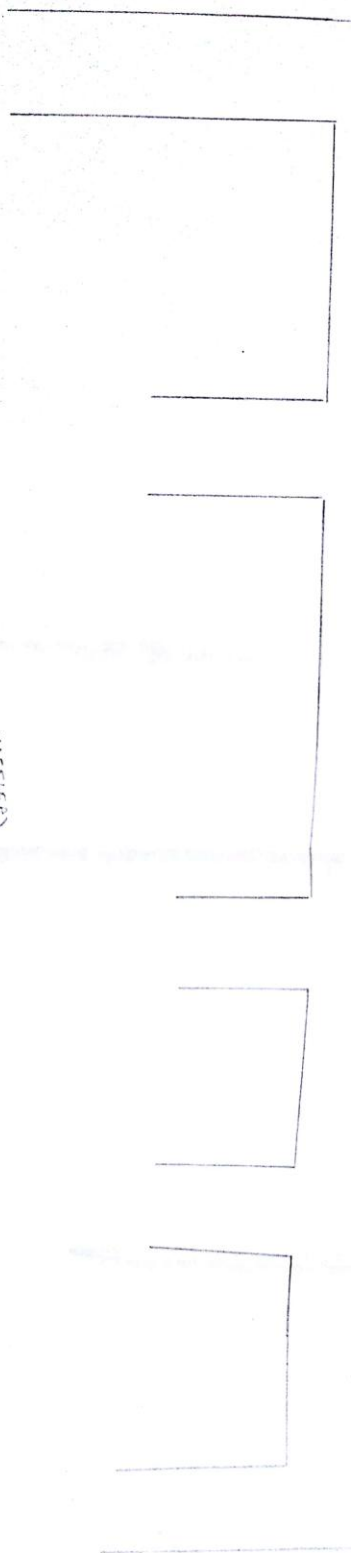
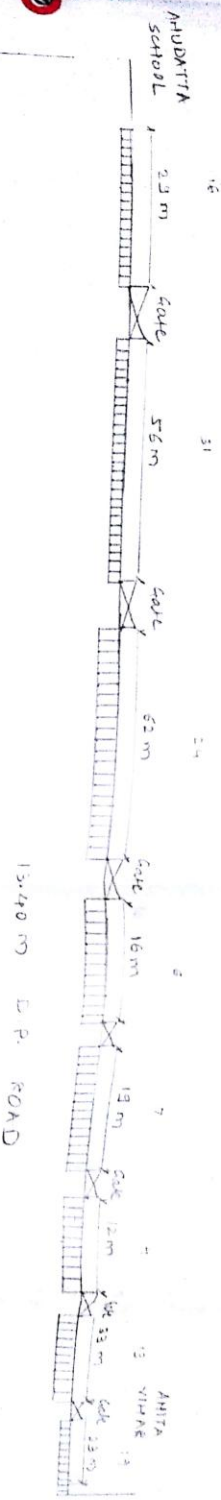

19 NOS. (TWO WHEELER)
12 M X 2.4 M

47 NOS (THREE WHEELERS)
1.80 M X 2.40 M

54 NOS (FOUR WHEELERS)
2.5 M X 5.5 M

56A)

ABZM)

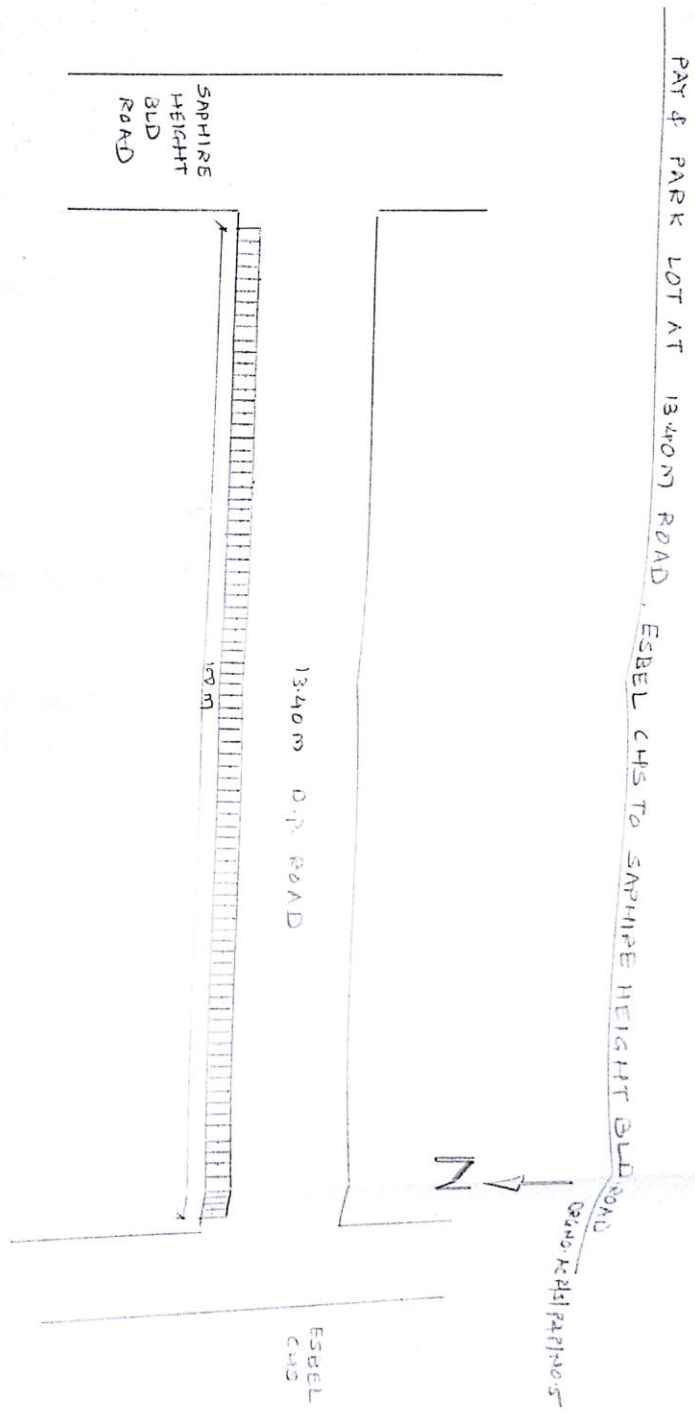

40 NOS (FOUR WHEELERS)
2.50M X 5.50M

56mm

15cm

PAY & PARK SLOT AT 13.40M ROAD NEIGHBORHOOD CHS TO SAFIRE HEIGHT BID ROAD

BRNO ACPH/PPH/MS

5

2-13

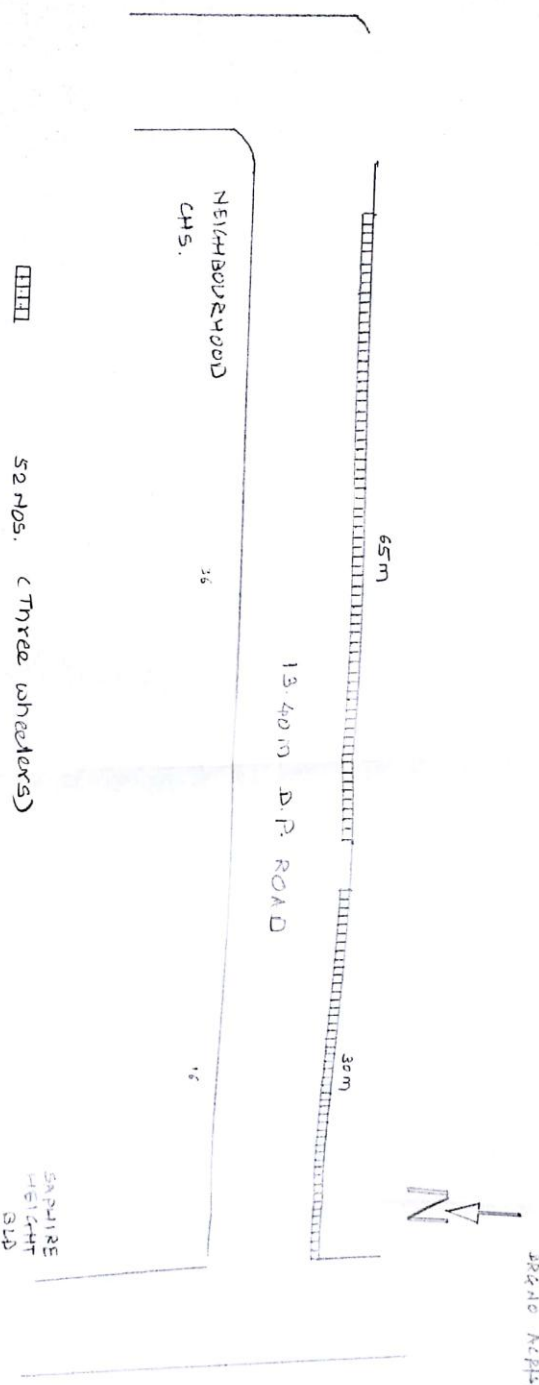

52 HDS. (THREE WHEELERS)

(SE 6m)

(AB 6m)

PAY & PARK SLOT AT 18.30M ROAD HIGHLAND CHS TO NEIGHBOURHOOD CHS

Public Access/Parking

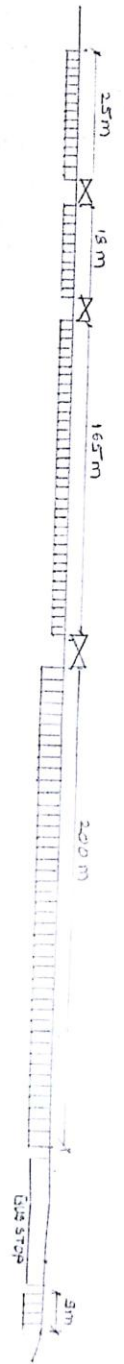

18.30M D.P. ROAD

Highland
CHS.

3

10

91

80

Neighbour-
hood
CHS.

3



114 nos. (Three wheelers)



83 nos. (Four wheelers)

2.50M X 5.50M

56 (5)

Accm

7
c. 95

ANUDATTA SCHOOL

PAY PARK LOT AT 1340M ROAD SAPPHIRE HEIGHT BLD TO ANUDATTA SCHOOL

DRAINAGE AREA 1221/10.2

(2)

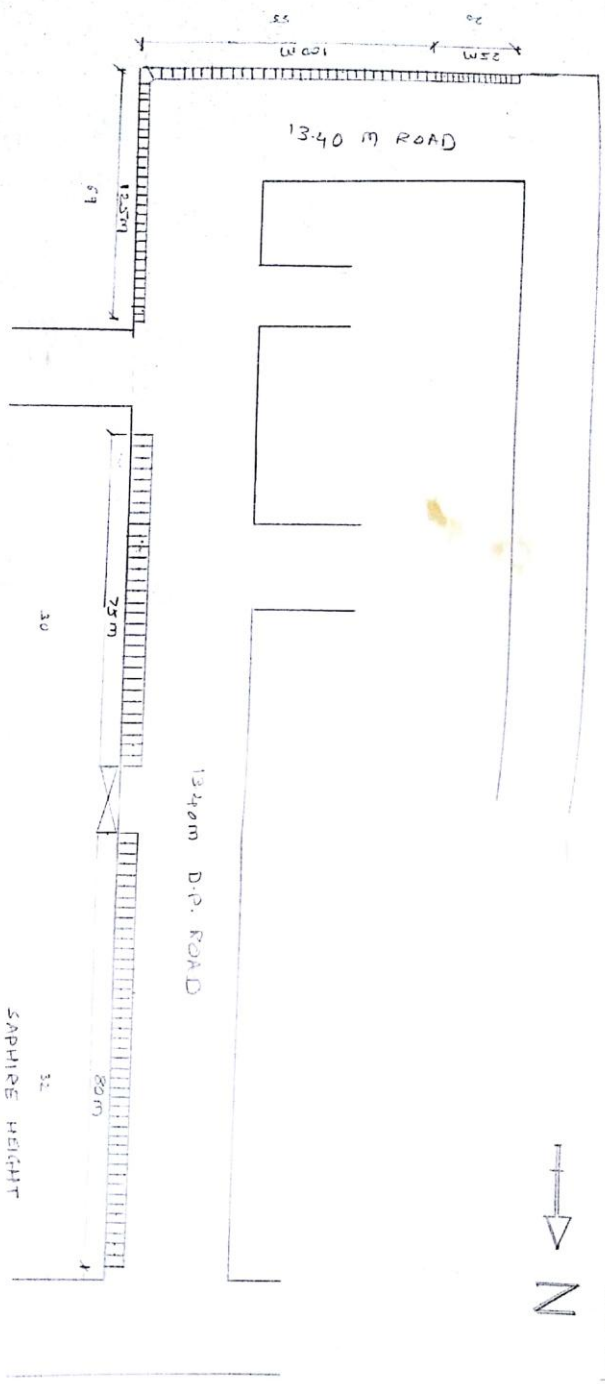

- 20 NOS. (TWO WHEELERS)
1.20M X 2.40M
- 124 NOS. (THREE WHEELERS)
1.80M X 2.40M
- 62 NOS. (FOUR WHEELERS)
2.50M X 5.50M

BL (SEC 2) (NEUM)